

SOUNDSTREAM

VIR-3200/ VIR-3200T

In-Dash 3.2" Monitor

Touch Sensor

DVD/MP4/CD

MW/FM Radio

Built-in NTSC tuner



Owner's Manual

Take the time to read through this owner's manual.

Familiarity with installation and operation procedures will help you obtain the best Performance from your new DVD-receiver.



Table of Contents

Table of Contents.....	1
Important Safeguards.....	2
Accessories	3
Installation/Un-Installation	4
Wiring Connections.....	5
Detachable Control Panel	6
Panel Controls.....	6
IR Remote Controls	8
General Operations.....	9
Digital Tuner.....	11
Memory Card/ USB Operations.....	12
Disc operations.....	14
MP3 overview.....	17
TV Operations.....	18
Compatible Files	19
SETUP Menu	19
Other Functions.....	21
Anti-theft system.....	21
Note on Discs.....	22
Troubleshooting Guide	23
Specification.....	24



Important Safeguards

- Using the device at temperature below -10°C may cause the breakage of the device. BEFORE USING PLEASE HEAT UP THE PASSENGER COMPARTMENT TO THE RECOMMENDED TEMPERATURE!
- Read carefully through this manual to familiarize yourself with this high-quality sound system.
- Disconnect the vehicle's negative battery terminal while mounting and connecting the unit.
- When replacing the fuse, be sure to use one with an identical amperage rating. Using a fuse with a higher amperage rating may cause serious damage to the unit.
- DO NOT attempt to disassemble the unit. Laser beams from the optical pickup are dangerous to the eyes.
- Make sure that pins or other foreign objects do not get inside the unit; they may cause malfunctions, or create safety hazards such as electrical shock or laser beam exposure.
- If you have parked the car for a long time in hot or cold weather, wait until the temperature in the car becomes normal before operating the unit.
- DO NOT open covers and do not repair yourself. Consult the dealer or an experienced technician for help.
- Make sure you disconnect the power supply and aerial if you will not use the system for a long period or during a thunderstorm.
- Make sure you disconnect the power supply if the system appears to be working incorrectly, (e. g, making unusual sounds, smelling strange, emitting smokes from inside or liquid having gotten inside it) Have a qualified technician check the system.
- The unit is designed for negative terminal of the battery, which is connected to the vehicle metal. Please confirm it before installation.
- Do not allow the speaker wires to be shorted together when the unit is switched on. Otherwise it may overload or burn out the power amplifier.
- Do not install the detachable panel before connecting the wire.
- Don't remove the detachable panel when encoding.

Accessories

Package contains the following accessories for installation and operation of the unit.

(1) Washer, Spring Washer, M5 Nut 1 each



(2) Mounting Strap 1



(3) Screw 1



(4) Bolt 4



(5) Mounting Collar 1



(6) Release Key 2



(7) Rubber Cushion 1



AV in Cable



Panel Carrying Case



Owner's Manual



Remote Controller

Installation/Un-Installation

First complete the electrical connections, and then check them for correctness.

Installation

This unit can be installed in any dashboard having an opening as shown on the picture. The dashboard should be 4.75 – 5.56 mm thick in order to be able to support the unit.

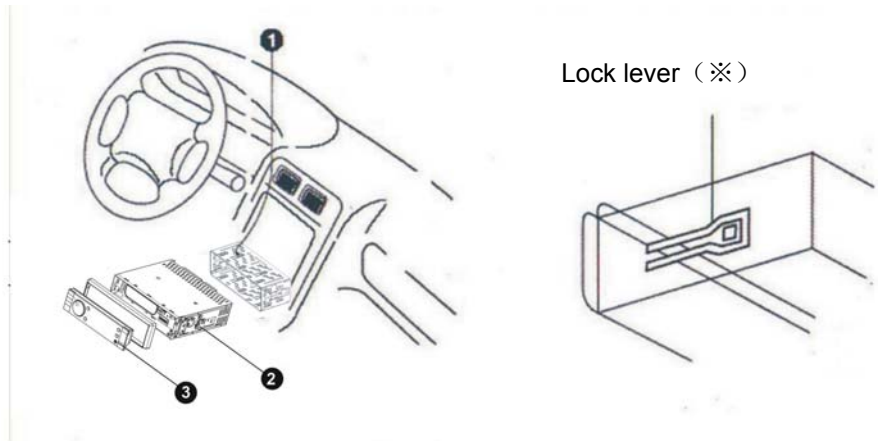

1. Insert mounting collar into the dashboard, and bend the mounting tabs out with a screwdriver. Make sure that lock lever (※) is flush with the mounting collar (not projecting outward).
2. Secure the rear of the unit.
After fixing mounting bolt and power connector, fix the rear of the unit to the car body by rubber cushion.
3. Insert trim plate.
When you prepare to insert trim plate, please check its direction. Once it was up side down, it cannot be fixed.

Un-installation

Remove Trim Ring and insert Release Keys into left and right side-end holes as shown in below picture and pull the unit out of the dashboard.

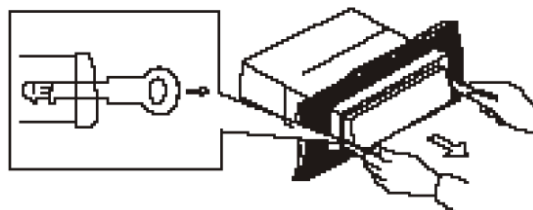

Wiring Connections

Make sure you have good chassis ground. A good ground connection will eliminate most electrical noise problems. A good chassis ground requires a tight connection to the vehicle's metal chassis. The area around the ground connection should be clean, bare metal without rust, paint, plastic, dust, or dirt for a good electrical connection.

****TV Antenna is for VIR-3200T only.**

Caution: Do not interchange the connection of the wiring!!!
For some car models you may need to modify wiring of the supplied power cord. Contact your authorized car dealer before installing this unit.

Using the ISO Connector

1. If your car is equipped with the ISO connector, then connect the ISO connectors as illustrated.
2. For connections without the ISO connectors, check the wiring in the vehicle carefully before connecting, incorrect connection may cause serious damage to this unit.
3. Cut the connector, connect the colored leads of the power cord to the car battery as shown in the color code table below for speaker and power cable connections.

FM: 87.5-107.9MHz AM: 530-1710KHz CAUTION: + 12V DC Negative Ground

ISO Speaker Connection

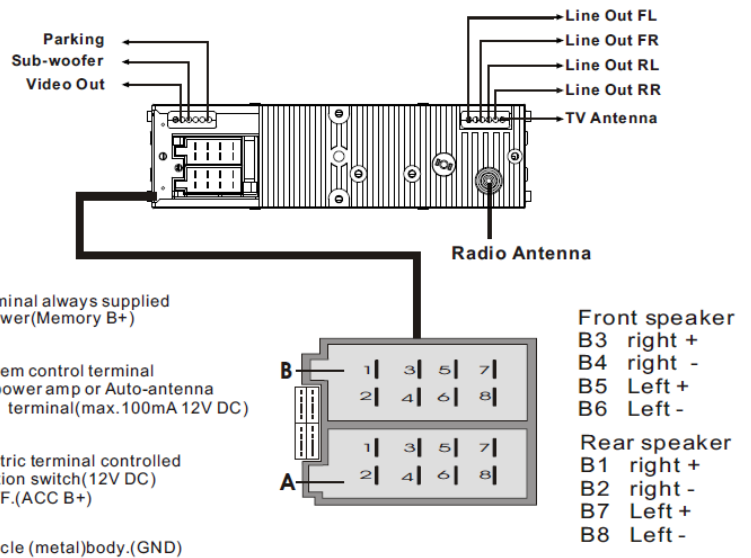

Location	Function	
	Connector A	Connector B
1		Rear Right(+)--Purple
2		Rear Right(--)--Purple/Black Stripe
3		Front Right(+)--Grey
4	Battery 12V (+)/yellow	Front Right(--)--Grey/Black Stripe
5	Auto Antenna/blue	Front Left(+)--White
6		Front Left(--)--White/Black Stripe
7	ACC+/red	Rear Left(+)--Green
8	Ground/black	Rear Left(--)--Green/Black Stripe

Detachable Control Panel

Detaching the control panel

- Turn the Power off.
- Press OPEN button release the panel.
- Pull the panel out.

Attaching the control panel

- Insert the left side of the control panel into the main unit.
- Press the control panel right side until the “click” sound is heard.

Caution:

DO NOT insert the control panel from the right side. It can damage the control panel.

The control panel can easily be damaged by shocks. After removing it, place it in a protective case and be careful not to drop it or subject it to strong shocks.

The rear connector that connects the main unit and the control panel is an extremely important part. Be careful not to damage it by pressing on it with fingernails, pens, screwdrivers, etc.

Note:

If the control panel is dirty, wipe off the dirt with soft, dry cloth only. And use a cotton swab soaked in isopropyl alcohol to clean the socket on the back of the control panel.

Panel Controls

Front panel

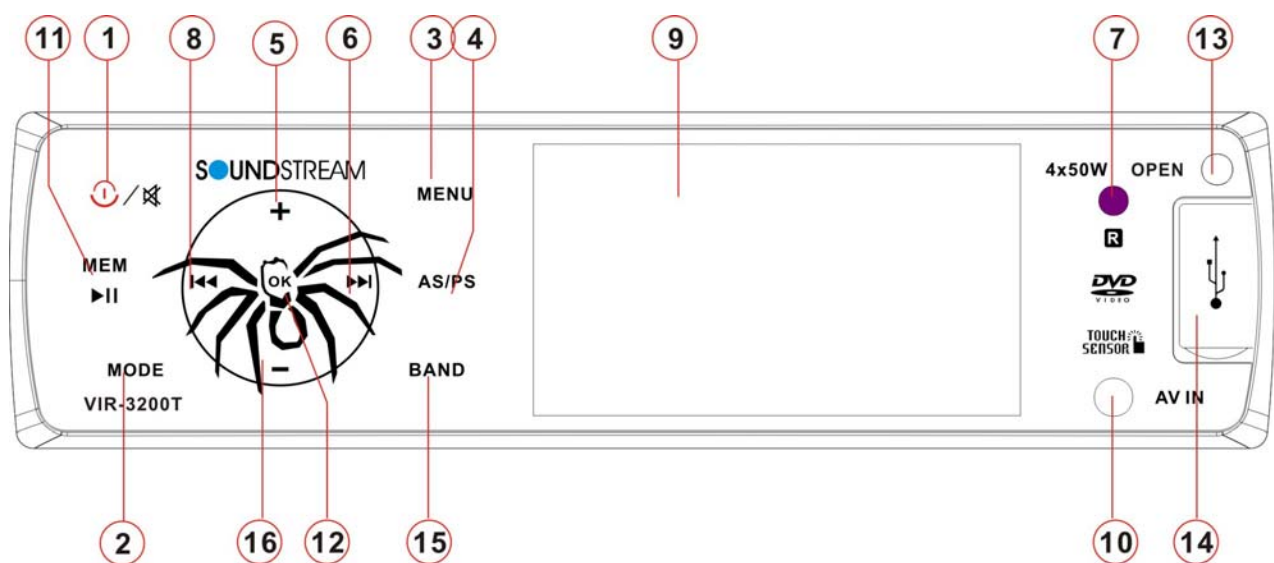

1. POWER/ MUTE
2. MODE
3. MENU
4. AS/PS
5. Volume Up (+)
6. NEXT
7. IR sensor
8. PREVIOUS

9. LCD
10. AV in jack
11. MEM/▶▶
12. OK
13. OPEN
14. USB jack
15. BAND
16. Volume Down (-)

Inner Panel

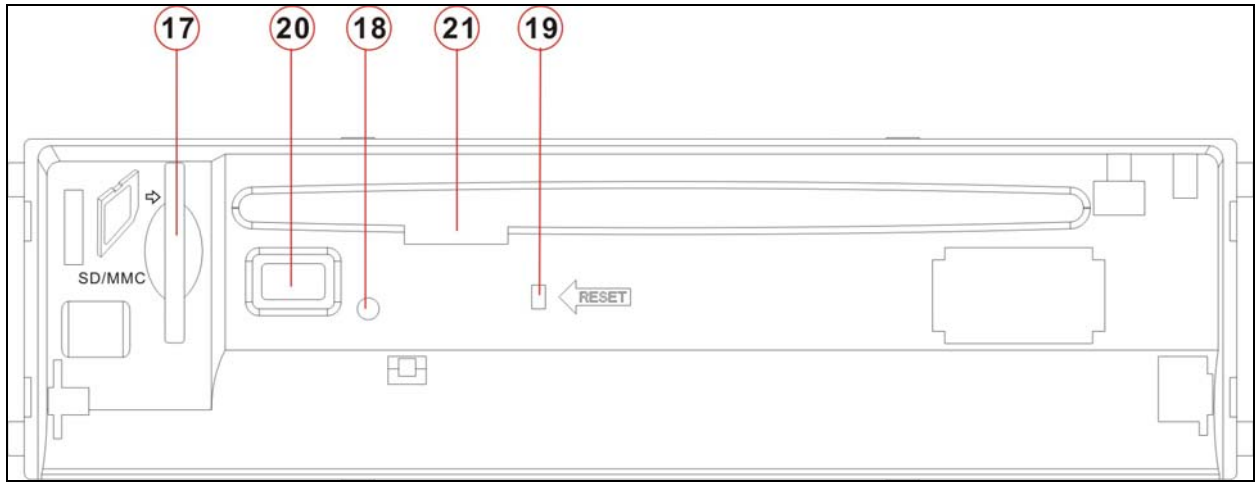

17. Memory Card slot
18. Flash LED
19. RESET

20. Eject button
21. Disc slot

IR Remote Control

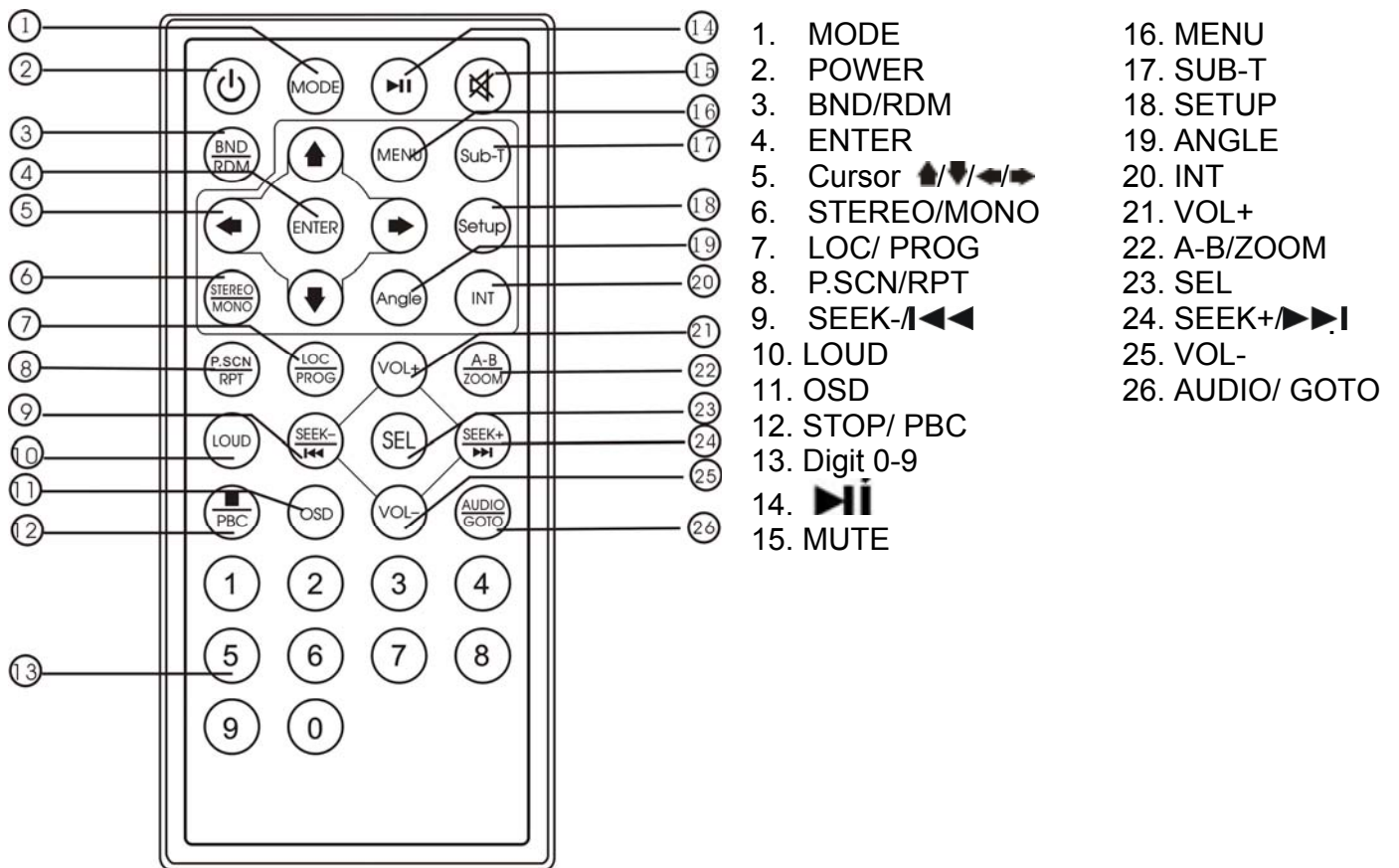

REPLACING THE BATTERY

Remote Control comes with a CR-2025 Lithium Battery included.

1. Remove the Battery Holder from the back of the Remote Control.
2. Insert a CR-2025 Lithium battery with the positive (+) mark upward. Insert the Battery Holder into the back of the Remote Control.

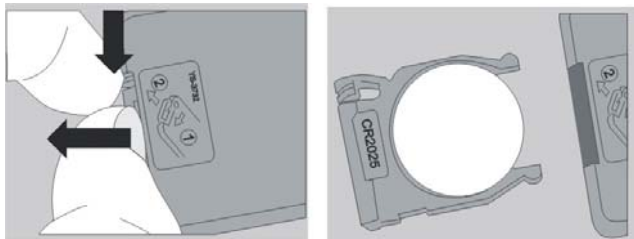

+3V
(CR 2025)

Warning: Store the battery where children cannot reach. If a child accidentally swallows the battery, consult a doctor immediately.

Do not re-charge, short, disassemble or heat the battery or dispose it in fire.

Do not expose or bring into contact the battery with other metallic materials. Doing this may cause the battery to give off heat, crack or start a fire.

When throwing away or saving the battery, wrap it in tape and insulate; otherwise, the battery may give off heat, crack or start a fire.



General Operations

Reset the Unit

In case the unit is malfunctioned or need to reset to factory default setting, press RESET button in inner panel then the unit will be reset.

Power on/off

Press "POWER" button to turn on the unit.

Long press POWER button on front panel or press POWER button on RC to power off the unit.

Mode Setting

Press MODE button on front panel or remote control to change mode in a sequence of:

Tuner => DVD => USB => Memory Card => TV => AV IN => Tuner

(When DVD/USB/ Memory Card available.)

Menu button

Press to enter MENU setting. Long Press Menu button on remote control can back to Main Menu.

Band button

In radio mode, press to select FM1-FM2-FM3-MW. In DVD mode, if playback mp3/wma files or contents of multi folders, press to move cursor ➡ right side, long press to move cursor ▼ downside.

OK button

In playing DVD mode, short press to enter and confirm;

In playing Radio mode, short press to enter and confirm;

MEM button

In playing DVD mode, short press to play / pause; long press to stop playing.

In playing Radio mode, short press to select manual storage stations.

Volume Control

Turn the knob on front panel clockwise/ counter-clockwise or press VOL +/- button on remote control to increase/ decrease the volume level.

MUTE Function

Short press POWER/MUTE button on the panel or press MUTE button on the Remote Control to mute. Press it again to cancel mute.

Audio Setting

Press SEL button on the Remote Control to select the audio setting:

BASS => TREBLE => BALANCE => FADER => EQ.

Press ▲/▼ buttons on remote to select the audio setting item (or press the VOL knob on front panel to select the setting item).

Press ENTER button or ➡ button on remote control or OK button on front panel to enter the selected item.

Press ◀/▶ buttons on remote to adjust the audio setting data (or press the |◀◀ ▶▶| knob on front panel to adjust the setting data).

Press SEL button on remote again to save the setting data and return to current mode.

Notes: If turn off the power, all the settings of each mode will be saved.

- If turn off the battery power, all the settings will be clear and become factory default setting.
- If you don't adjust setting within 3 seconds after selecting the desired setting item, the unit will automatically return to the current mode.

Menu Settings

Press MENU button on front panel or remote control to enter MENU setting.

During FM mode press the MENU button to enter the setting mode.

Press ▲/▼ buttons on the remote control or press the VOL knob on front panel to select the setting.

Press ENTER button or ► button on remote control or OK button on front panel to enter the setting.

Press ◀/▶ buttons on remote control or press the |◀◀ ▶▶| knob on front panel to adjust the setting.

Press ENTER button or ► button on remote control or OK button on front panel to confirm, press MENU to return to last settings list.

- In Radio mode short and repeat press the OK button to select these settings:
AUDIO=> EXPERT => CLOCK
- In USB/Memory Card mode short and repeatedly press the OK button to select these settings:
AUDIO => PICTURE => EXPERT => CLOCK

● AUDIO MENU

MENU	DESCRIPTION(tuning by left or right arrow)
BASS	Support 10 levels. Default level is 0.
TREBLE	Support 10 levels. Default level is 0.
BALANCE	Support 10 levels for each left and right channel. Default is left equal to right.
FADER	Support 10 levels for each front and rear channel. Default is front equal to rear.
EQ DSP OFF	FLAT→CLASSICS→POP→ROCK→DSP OFF

● PICTURE MENU

MENU	DESCRIPTION
RED	Adjust level of red color. Support 50 levels. Default level is 25.
GREEN	Adjust level of green color. Support 50 levels. Default level is 25
BLUE	Adjust level of blue color. Support 50 levels. Default level is 25.
BRIGHTNESS	Adjust level of screen brightness. Support 50 levels. Default level is 25
CONTRAST	Adjust level of screen contrast. Support 50 levels. Default level is 25.
SHARPNESS	Adjust level of screen sharpness. Support 15 levels. Default level is 10
SCREEN	Adjust screen size: 16:9 →4:3→FULL
COLOR RESET	Resume color default status. (Select YES or NO by navigation buttons, and press ENTER button on remote control or OK button on front panel to confirm "YES")

● EXPERT MENU

MENU	DESCRIPTION
DX	Set search radio station by DX or LOCAL mode. DX→LOCAL
STEREO	Set radio audio at STEREO or MONO mode, STEREO→MONO
BEEP	Set press keys' sound. 2ND→ALL→OFF
LOUD	Set loudness on or off. OFF→ON
SUBWOOFER	Set subwoofer ON→OFF
BACKLIGHT	Set OSD BACKLIGHT: HIGHT→LOW →MID
OSD COLOR	Set OSD COLOR:DARK BLUE→VIOLET→LIGHT BLUE

● CLOCK MENU

MENU	DESCRIPTION
CLOCK	Set CLOCK display time or not. Off / on.
CLOCK HOUR	SET CLOCK 12H/24H
CLOCK ADJUST	Set CLOCK ADJUST time

On-Screen Display (OSD)

In USB/ Memory Card/DISC mode, short press to show Memory Card /USB/DISC information on the display, long press one time to show the current playing track/ played time information, long press twice to show the current playing track/ remainder time for play, long press again to clear the information.

Driver Safety Function

Note: To watch video the parking wire should be connected to break signal.

Caution! The parking wire is connected with brake signal; for driving safety, the video programs should only be viewed after the car is parked. Check and follow your local authority's regulations regarding watching video in a car.

Digital Tuner

Note: Memory Card /**USB** service availability varies with areas. Please understand if Memory Card /USB service is not available in your area, the following service is not available, either.

Band selection

Press MODE button to select the RADIO mode.

Press the BAND button to select the desired band: FM1=> FM2 => FM3 =>MW

Manual/ automatic tuning

- **Manual tuning:** press the **|◀◀▶▶|** buttons on remote control and hold for 2 seconds to enter the manual tuning mode. Press the **|◀◀▶▶|** buttons on the panel or on the Remote repeatedly to select a station downward or upward step by step.
- **Automatic tuning:** press the **|◀◀▶▶|** buttons on the Remote or press **|◀◀▶▶|** buttons on front panel and hold for 2 seconds, the automatic search will start. It will play when finds the station.



Preset station 1-6 play and setting

- **Play preset station:** to play the preset station 1-6, you can press number key 1-6 on remote control, **Preset station setting:** during manual tuning or automatic tuning, press and hold the number 1-6 buttons on remote to store the preset station 1-6 or press MEM button on front panel and rotate VOL knob to select the preset station 1-6 and press OK button to store.

Remark: You can store up to a total of 24 radio stations in the memory (18FM, 6MW).

AS (Auto Store) / PS (Preset Scan)

AS (Auto Store): In tuner mode, Press the RPT/P.SCN button on the remote and hold for 2 seconds to store radio station's with the best reception to the preset buttons automatically.

PS (Preset Scan): In tuner mode, press this button to scan the preset memorized station, each preset scan for 5 seconds. Press again to stop operation.

Memory Card/ USB Operations

USB Flash Memory

To play MP3/ MP4/ WMA files from a USB flash memory, insert a USB flash memory into the USB port on the right side of the unit. The unit will start playing MP3/MP4/ WMA files on the USB flash memory automatically. Or press the MODE button to select USB after pressing POWER button to turn on the unit.

Memory CARD

To play MP3/ MP4/ WMA files on a Memory CARD, insert the card into the card slot (you should press the OPEN button on the panel to flip down front panel and insert the card into card slot.) The unit will start playing MP3/ MP4/ WMA files on the Memory card memory automatically. Or press the MODE button to select Memory Card after pressing POWER Button to turn on the unit.

PAUSE/ PLAY

Press the PLAY/ PAUSE button to pause the playback. Press the button again to resume.

STOP

Press the STOP button on remote to stop playback. Press the PLAY/ PAUSE button to resume. If the Memory card or USB is removed, the resume function will be cancelled.

Press the STOP button twice to stop the playback totally. Press the PLAY/ PAUSE button to start playback from the beginning.

Selecting Tracks

If the MP3/ MP4/ WMA files are stored in the folders on the USB drive or Memory Card, the unit will start by playing the first song in the first folder. After playing all the files sequentially in the first folder, the unit will play all the files sequentially in the next folder. The unit will continue playing through all of the folders on the USB drive or Memory card in this manner. Press the **◀◀** button to play the previous track/chapter. Press the **▶▶** button to play the next track/chapter. Press the digital buttons (0-9) to select the desired track/chapter.

On front face, press BAND button to move cursor right side for select track, press BAND button and hold for 2 seconds to move cursor downward for select folders.



Changing the Subtitle Language (only for MP4 files)

Press SUB-T button on the remote to select the preferred language for sub-title.





ZOOM (only for MP4 files)

Press ZOOM button and hold for 2 seconds on remote to activate zoom function in the following sequences: ZOOM 2 => ZOOM 3 => ZOOM 4 => ZOOM 1/2=>ZOOM 1/3=>ZOOM 1/4=>ZOOM OFF.

Rotate Picture (only for picture files)

In picture mode, press / buttons to rotate picture 90 degrees.

System Menu

In USB/ Memory Card mode, press SETUP button on remote to show system menu. Press /// buttons to set system data, press this button again to save input data and exit system menu.

Discs operations

Glossary

PBC (Play Back Control)

Play Back Control is a menu recorded on the disc with SVCD or VCD2.0 format. For the discs contained PBC, it can playback interactive software with the menu displayed on TV. And if the disc contains still images, it can playback high definition of still image.

Title

The title is the important part of DVD disc. The memory volume of the disc is rather big, that makes possible to record several films on one disc. For example, if a disc contains three films, they may be divided into Title 1, Title 2 and Title 3. You can easily use the functions to search.

Chapter

A title can be divided into several blocks, so that every block can be operated as a unit, the unit is called chapter.

The chapter contains a unit at least.

Track

It is the biggest component of VCD. Generally, every song of Karaoke disc is a track.

Discs for playback

- This unit can play:

DVD/SVCD/VCD/HDCD/MP3/MP4/WMA/CDDA/Picture-CD/JPEG/CD-R/-RW/DVD±R/±RW.

- The following file types are supported:

Audio files: MP3 (*.mp3)

WMA (*.wma)

Video files: MP4 (*.avi, MPEG43.11/4.0/5.0/6.0 and XVID)

MPEG 2(*.vob)

MPEG 1(*.dat)

Picture file: JPEG (*.jpg)

- ISO 9660 or ISO 9660 +Joliet format - Max. 30 characters
- Max. Track number is 448
- Max. nested directory is 8 levels
- The max. album number is 99
- The max. length of each track is 99 minutes 59 seconds
- Supported sampling frequency for MP3 disc: 8 KHz to 48 (44.1 KHz preferably) KHz
- Supported bit-rates of MP3 disc are: 32 - 320 kbps (128 kbps preferably).
- Following formats are NOT supported *.ACC, *.DLF, *.M3U, *.PLS, MP3 PRO, files with DRM.
- Open session discs are NOT supported.

Loading a disc

1. Turn the power on.
2. Press the Open button on the front panel to flip it down.
3. Insert the disc with the printed side facing upward into the slot. The panel will be closed automatically. The DVD mode will be turned on automatically. The monitor will show the disc content.
4. Press Open button on the panel and Eject button inner the panel to eject the disc. If the disc is not removed for about 10 seconds after reject, the disc will reinserted automatically. When disc in/out, put front panel at 0 degree to avoid distort the disc.
- 5 You may also choose the playing mode using the MODE button.

Playing/pausing

To ensure good system performance, wait until the unit finishes reading the disc information before proceeding.

Press the PLAY/ PAUSE button to start/ pause the playback. In pause mode press it again to resume the playback.

Stop

During playback press the STOP button on the RC. Playback will be stopped. Press the PLAY/ PAUSE button again to start playback from the position at which it was stopped. If the disc is removed, the resume function is cancelled.

Press the STOP button twice to finally stop the playback. Press the PLAY/ PAUSE button to start playback from the very beginning.

Playing the previous/ next track/ chapter

1. During playback press the **⏮** button to start playing the previous track/chapter.
2. Press the **⏭** to start playing the next track/chapter.
3. Press the digital buttons (1-9, 0) buttons to enter the desired track/chapter number.

Speed forward and backward

Long press the **⏮/⏭** buttons on the panel or press and hold for 2 seconds the **⏮** or **⏭** on the RC to select the speed of fast playing in backward or forward direction: X2, X4, X8, X16, X32 Press the PLAY/PAUSE button to return to normal playback.

Note: During the disc playback when Fast/ Reverse Playback gets to the beginning of the playing another track, it resumes normal playback.

Repeat playback

Press the RPT/P.SCN button on the RC once or more times to repeat the playback:

- For VCD/CD: display appears Repeat Track => Repeat Disc => Off (Some discs do not support this functions).
- For DVD: display appears Repeat Chapter => Repeat Title => Off
- For File disc: display appears File => Folder=> All => Off

Note: to choose FOLDER repeating and TITLE repeating press and hold RPT button.

Repeat A-B function

1. During playback, press A-B button on the remote control at the starting point of the section you want to repeat (point A).
2. Press A-B button again at the ending point of the section you want to repeat (point B). Section A-B repeating starts.
3. Press A-B button again to cancel the A-B repeat function.

Random playback (for CD/VCD/MP3 discs)

During disc playback, press the RDM button on the RC to start random playback of the disc. Press again to cancel.

Intro playback (for CD/VCD discs)

You can play the beginning of every track for 10 seconds in sequence. Press the INT button on remote control to start intro play of whole disc. Press again to cancel.

PBC (Playback Control) function (for VCD only)

If you insert a VCD with PBC, playback starts from the beginning of the 1st track automatically.

1. Long press PBC/STOP button to activate interactive menu on screen during playback.
2. If the menu consists of titles, you can select a desired one using the **◀◀/▶▶** buttons.
3. The VCD starts playing the selected title automatically or press PLAY/ PAUSE button to confirm the selected track for playback.

Programming the playback

1. Press PROG button on the RC to enter program list.
2. Use **▲, ▼, ◀, ▶** buttons and digit buttons to enter the number of the desired track to be on selected position.
For DVD and File disc, select title and chapter number.
For VCD and CD, select track number.
3. Press PLAY/ PAUSE button to play, or move the cursor to select PLAY and press ENTER to play.
4. If you want to delete the list, move the cursor to CLEAR, press ENTER to delete all the list set before.
5. Press PROG again to exit program play.





Selecting different audio modes

- For DVD disc: press AUDIO on the RC repeatedly to select the audio language to listen (if the disc supports multi-language mode).
- For VCD disc: press AUDIO on the RC repeatedly to select the following modes:
L R STEREO (Channel left => Channel right => Stereo).

Changing the subtitle language (for DVD only)

Press SUBTITLE button on the RC to select the preferred language for the disc menu. When the selected language is recorded on the disc then this language will automatically be selected. If not, the first language recorded on the disc is displayed.

Changing size

Press and hold for 2 seconds the A-B/ZOOM on the RC. The picture will be enlarged accordingly: X2 => X3 =>X4 => X1/2=>X1/3=>X1/4X=>Normal.

Changing angle (for DVD only)

If DVD discs support multi-angle playback, press ANGLE on the RC button to playback images in different camera angles. If discs doesn't support multi-angle playback, this function will not work. If no operation within 1 second, angle description will disappear.

Menu navigation (for DVD only)

Press and hold MENU button on remote control to activate the disc menu list on the screen.

Choose the desired item by pressing cursor up/down/left/right buttons.

Press ENTER button on remote control or OK button on front panel to confirm the selected item and start playing.

Note: Menu function is only available if the disc with this function.

MP3 overview

Notes on MP3:





- MP3 is short for MPEG Audio Layer 3 and refers to an audio compression technology standard.
- This product allows playback of MP3 files on CD-ROM, CD-R or CD-RW discs.
- The unit can read MP3 files written in the format compliant with ISO 9660. However it does not support the MP3 data written by the method of packet write.
- The unit can not read an MP3 file that has a file extension other than “.mp3”.
- If you play a non- MP3 file that has the “.mp3” extension, you may hear some noise.
- In this manual, we refer to what are called “MP3 file” and “folder” in PC terminology as “track” and “album”, respectively.
- Maximum number of directory level is 8, including the root directory. Maximum number of files and folders per disc is 448.
- The unit may not play tracks in the order of Track numbers.
- The unit plays only the audio tracks if a disc contains both audio tracks and MP3 files.
- When playing a disc of 8 kbps or “VBR”, the elapsed playing time in the display window will not be correct and also the intro play may not function properly. “VBR”: Variable Bit Rate.



Notes on creating your own CD-R or CD-RW containing MP3 files:

- To enjoy high quality sound, we recommend converting to MP3 files with a sampling frequency of 44.1 kHz and a fixed bit rate of 128 kbps.
- DO NOT store more than 448 MP3 files per disc.
- For ISO 9660 - compliant format, the maximum allowable depth of nested folders is 8, including the root directory (folder).
- When CD-R disc is used, playback is possible only for discs, which have been finalized.
- Make sure that when MP3 CD-R or CD-RW is burned that it is formatted as a data disc and NOT as an audio disc.
- You should not write non-MP3 files or unneeded folders along with MP3 files on the disc otherwise it takes a long time until the unit starts to play MP3 files.
- With some CD-R or CD-RW media, data may not be properly written depending on its manufacturing quality. In this case, data may not be reproduced correctly. High quality CD-R or CD-RW disc is recommended.
- Up to 16 characters are displayed for the name of an Album or a Track. ID3TAG version 1.x is required.
- Note that the unit may not play Tracks in the order that you wrote them to the disc.

TV OPERATIONS (FOR VIR-3200T ONLY)

1. Connect TV antenna, and then press MODE button to select TV mode.
2. In TV mode, press the MENU button once to enter TV menu setting.
3. Press the /  buttons to select one of the setup pages: Auto program => Manual program.
4. Press OK button on front panel or ENTER button on remote control to enter the page.
5. Press the /  buttons to select the setting.
6. Press OK button on front panel or ENTER button on remote control again to confirm, press MENU to return to settings list.

TV MENU

Auto program (Auto seek mode)

System

Select this menu item to set TV video system: NTSC=>PAL, press OK button on front panel or ENTER button on remote control to select.

Audio

Select this menu item to set the TV sound system: AUDIO1=> AUDIO2=> AUDIO3, press OK button on front panel or ENTER button on remote control to select.

Search

Select this menu item is to start searching and storing stations automatically.

Manual program (manual seek mode)

Storage

Select this menu item to set the storage number.

System

Select this menu item to set TV video system: NTSC=>PAL, press OK button on front panel or ENTER button on remote control to select.

Audio

Select this menu item to set the TV sound system: AUDIO1=> AUDIO2=> AUDIO3, press OK button on front panel or ENTER button on remote control to select.

Channel

Select this menu item is to set your desired searching channel, press cursor left/right buttons on remote control to select one.

Fine

Select this menu item is to fine TV picture and sound until it achieves the best quality, press cursor left/right buttons on remote control to adjust.

Memory

Select memory on or off is to set whether memory the searched station or not, press press OK button on front panel or ENTER button on remote control to select.

Notes:

TV cannot be displayed on the additional monitor.

Compatible Files

1. Audio files:

MP3, WMA

2. Video files:

MPEG4 TM1 3.11, 4X, 5X and 6X versions

Nero Digital TM2

Real time MPEG2 MP@ML display

Real time MPEG1 D1 (720X480X30/ 720X576X25) decoding

Setup Menu

- Press SETUP button to enter the system settings main menu;
- Press cursor ◀/▶ buttons to move along icons on the top navigation bar on settings main menu. Select one of the setup pages: System, Language, Audio, Video, Digital;
- Press cursor ▲/▼ buttons to choose a setting or return to the Setup Page;
- Press cursor ▶ button to enter the highlighted setting;
- Press ENTER button on remote control or OK button on front panel to confirm your setting.

System Setup

TV system

Select this menu item to set up your preferred video output format.

TV type

Set TFT screen mode to the correct ratio:

Three screen ratios are available, 4:3 PS (4:3 Pan Scan), 4:3 LB (4:3 Letter box) and 16:9.

Different disc formats will display in different screen ratio, depending on this setting and the screen size used.

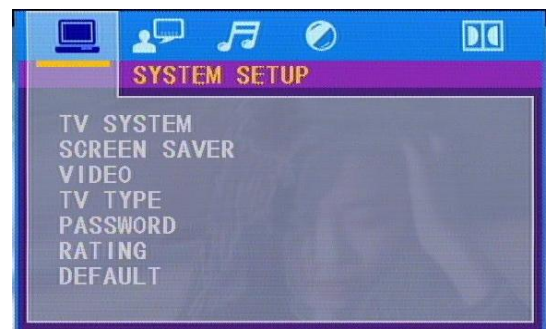

Password

The password for this unit is initially set to factory default. You must enter password if your want to set up rating control. If you want to set up Rating, enter the default password 0000, and then press OK button on front panel or ENTER button on remote control to confirm it, now you can set rating control. If you want to change your password, you need to enter old password first and confirm it, and enter a new password and confirm.

Rating

For DVD discs which support rating system, setting up rating control can prevent children from watching content that might not be suitable to their age.

Commonly used rating codes:

Code	Description
None	Kid safe
G	General Audiences - All ages admitted
PG	PARENTAL GUIDANCE SUGGESTED - Some material may not be suitable for children
PG-13	PARENTS STRONGLY CAUTIONED - Some material may be inappropriate for children under 13
PG-R	Restricted, under 17 requires accompanying parent or adult guardian.
R	RESTRICTED - Under 17 requires accompanying parent or adult guardian
NC-17	NO ONE 17 AND UNDER ADMITTED
Adult	Above 17 Admitted

Default setup

With this option you can clear all your setup and resume factory default settings.

Language Setup

OSD language setting:

With this menu item you can select the language for your On Screen Display (OSD).

Audio language setting:

With this menu item you can select the preferred language for the audio output (this function requires MP4 file support).

When the selected audio language is recorded on the disc, then this language will automatically be played. If not, the first language recorded on the disc will play.

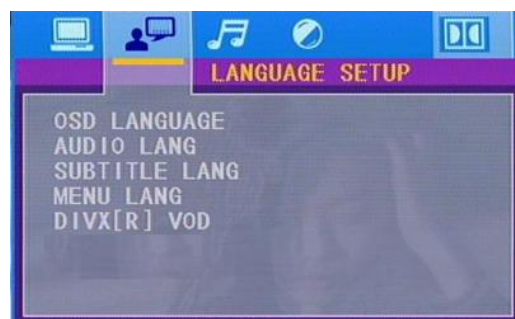

Subtitle language setting:

With this menu item you can select the preferred language for the subtitles (this function requires MP4 file support). When the selected subtitle language is recorded on the disc then this language will

automatically be displayed. If not, the first subtitle language recorded on the disc is displayed.

Menu setting:

With this menu item you can select the preferred language for the disc menu (this function requires disc support). When the selected menu language is recorded on the disc then this language will automatically be selected. If not, the first language recorded on the disc is displayed.

Audio Setup

Key

This menu item serves to set the key tone of music.

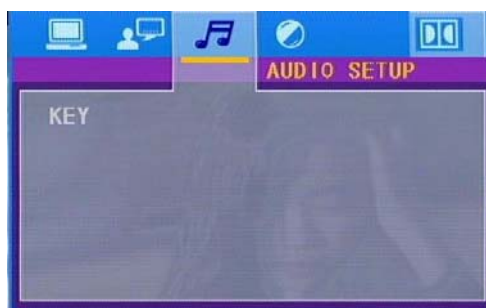

Video Setup:

Brightness

With this menu item you can set up the brightness of the image.

Contrast

With this menu item you can set up the contrast of the image.

Hue

With this menu item you can set up the hue.

Saturation

With this menu item you can set up the color saturation.

Sharpness

With this menu item you can set up the sharpness of the image.



Digital setup

Dynamic range

This function is to obtain different compression results of the audio signals, default is set to "OFF".

If select FULL, the max audio signal is minimum.

Dual mono

With this menu item you can select the type of Left and Right channel audio output. Stereo is normal Stereo, Mono L is all sound on the Left Audio output, Mono R is all sound on the Right channel. The "Mix Mono" function only works when a DVD is being played in DTS 5.1 mode.



Other functions

Subwoofer

Connect the subwoofer to the unit using sub output (see electrical diagram). Press MENU button, choose expert and set subwoofer ON to enable subwoofer.

Anti-theft system

Remove the panel

1. Press the PWR button to turn the power off.
2. Press OPEN button to detach the panel.
3. Pull the panel out.
4. Place the panel into the case and take it with you when you leave the car.

Remove the unit

1. Remove the panel and the trim plate.
2. Insert both T-Keys into hole on the front of the set until they lock.
3. Pull out the unit.

Note on Discs

- ✧ Only use groundless loudspeakers.
- ✧ Use only loudspeakers of minimal 40Watt, using fewer watts may result in damaging your loud speakers at higher volumes.
- ✧ Use 4~8 Ω (Ohm impedance) loudspeakers only; using higher or lesser impedance may damage the unit.
- ✧ Do not use 3-cable loudspeakers and do not connect the loudspeakers minus to the car body.
- ✧ (GND). using a BTL circuit and each loudspeaker must be connected with insulated cables according the diagram.
- ✧ Loudspeaker cables and/or optional external power amplifiers must always be about 30cm. away from the antenna and/or antenna extension parts.
- ✧ If want to display for 3.2" TFT, parking wire must be connected to ground.

Handling discs

Handling

When holding
With both hands



When holding
with one hand



- Do not use damaged (cracked or warped) discs.
- Do not scratch the signal surface or let it get dirty.
- Do not attach paper or seals to discs. The player may be damaged if there is any exposed glue, etc., on discs. For rental discs in particular, extra labels are often attached to the discs. Check carefully for any exposed glue before using such discs.



Storing discs

- Always place discs in their case and store them vertically. Avoid storing discs in hot or humid places, places exposed to direct sunlight and places in which the temperature is extremely low.
- Read any cautions included with the discs carefully.

Cleaning discs

- Fingerprints or dust on discs may reduce sound or picture quality. Remove them by gently wiping the disc from the center toward the edges using a soft cloth.

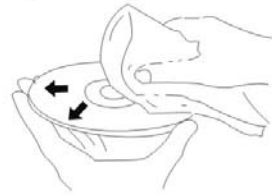

- Do not use benzene, thinner or other volatile chemicals. Do not use record spray or antistatic spray either.
- We recommend using the separately sold cleaning set to clean discs.
- For tough dirt, apply some water to a soft cloth, wring out thoroughly, wipe off the dirt, then wipe the disc with a dry cloth.

Irregular shaped discs
Irregular shaped discs (heart-shaped discs, hexagonal discs, etc.) cannot be played on this player. Doing so could damage the player. Never use such discs.



Troubleshooting guide

Symptom	Cause	Solution
General No power	The car ignition is not on. The fuse is blown.	If the power supply is properly connected to the car accessory switch the ignition key to "ACC". Replace the fuse.
Disc Disc cannot be loaded.	Presence of disc inside the player	Remove the disc in the player then put a new upward.
Disc cannot be read.	Inserting the disc in upside down. Compact disc is extremely dirty or defective. Temperature inside the car is too high.	Insert the compact disc with the label facing upward. Clean the disc or try to play a new one. Cool off until the ambient temperature returns to normal.
No sound	Volume is in minimum. Wiring is not properly connected.	Adjust volume to a desired level. Check wiring connection.
The operation keys do not work.	The built-in microcomputer is not operating properly due to noise. Front panel is not properly fix into its place.	Press the RESET button. Reinstall the front panel.
Sound skips.	The installation angle is more than 30 degrees. The disc is extremely dirty or defective.	Adjust the installation angle to less than 30 degrees. Clean the compact disc/try to play a new one.
The radio does not work, the radio station automatic selection does not work.	The antenna cable is not connected the signals are too weak.	Insert the antenna cable firmly select a station manually.

Specification

General	
Power supply:	12 V DC
Current consumption:	max. 10 A
Maximum power output:	40W x 4 channels
Compatible formats:	DVD/SVCD/VCD/HDCD/MP3/MP4/WMA/CDDA/Picture-CD/JPEG/CD-R/ -RW/DVD±R/±RW playback
Dimensions (W x D x H) / weight:	178 x 175 x 50 mm / 1.8 kg
ESP function:	40 sec. for Audio CD, 120 sec. for MP3
Working temperature range:	-10°C - +60°C
TFT display	
Screen size:	3.2 inch
Resolution:	320*3*240 dot
Aspect ratio:	4:3/16:9
Contrast ratio:	400:1
Brightness:	250 cd/m2
FM Stereo Radio	
Frequency range:	87.5 – 107.9 MHz
Usable sensitivity:	≤15dB
Preset memory stations:	18
MW section	
Frequency range:	530 kHz - 1710 kHz
Preset memory stations:	6
Audio specification	
Maximum output:	1.5 Vrms (+/- 3 dB)
Frequency response:	20 Hz - 20 KHz
S/N ratio(A-vtd):	68 dB
DSP sound effect:	Classic, Rock, Pop, Flat and none
Line out	
Line outs:	4 channel RCA line-out 1 channel Subwoofer pre-out
Video Output	Video Output Impedance: 75Ω Video Output Level: 1.0±0.2V (under normal video input level)

Specifications are subject to change without notice. Mass and dimension are approximate.